

SECTION B-B

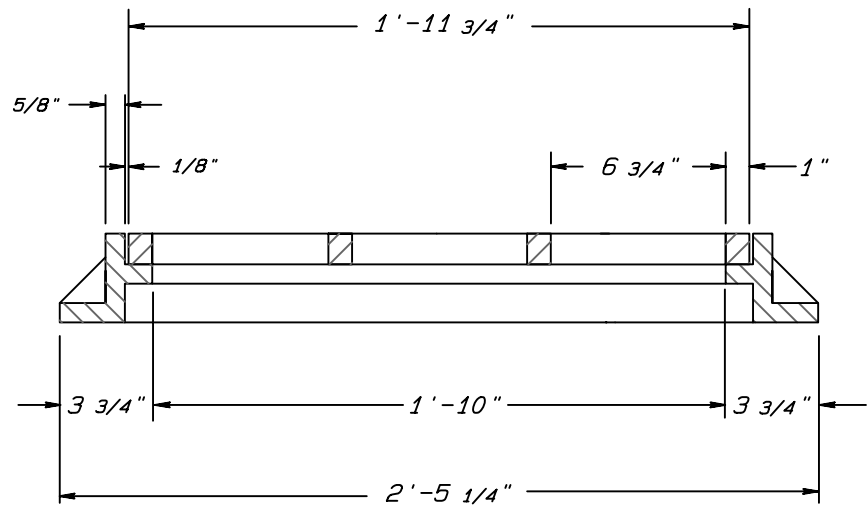

SECTION A-A

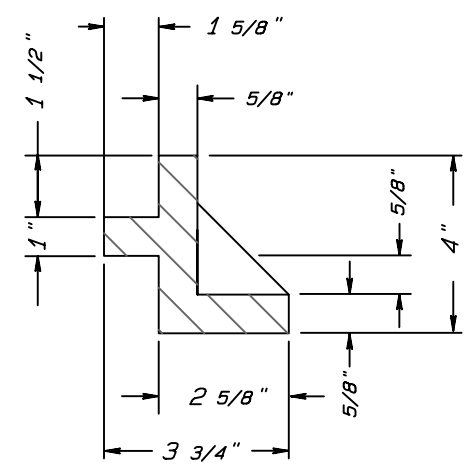

FRAME DETAIL

HEAD	CAPACITY
1"	1.75 cfs
3"	3.1 cfs
6"	4.3 cfs
9"	5.3 cfs
12"	6.1 cfs

CB-3A
V-5622-80, V-5622
USF 6259/4134

NOTES:

1/4" FILLET ON ALL INSIDE CORNERS
FRAME CAN BE USED WITH FLANGE UP.
THIS GRATE & FRAME NOT TO BE USED
IN LOCATIONS SUBJECT TO TRAFFIC.

CITY OF GREENSBORO

**STANDARD 24" X 24" GRATE
AND FRAME (LIGHTWEIGHT)**

STD. NO.	REV.
406	01-97 03-98 08-08