

TONGUE AND GROOVE PIPE

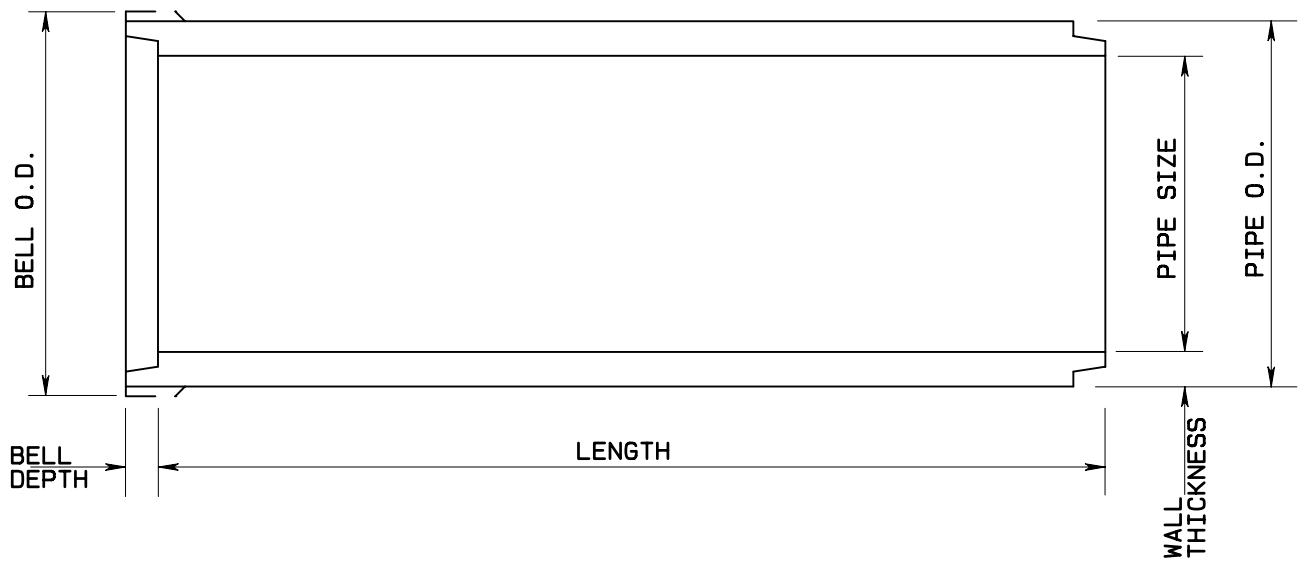

PIPE SIZE	WALL	BELL DEPTH	PIPE O.D.	BELL O.D.	LENGTH	LB / FT
12"	2"	1 3/4"	16"	17 1/2"	4' & 8'	100
15"	2 1/4"	2 1/4"	19 1/2"	20 1/2"	4' & 8'	135
18"	2 1/2"	2 1/4"	23"	24"	4' & 8'	175
21"	2 3/4"	2 1/4"	26 1/2"	27 1/4"	4' & 8'	225
24"	3"	3"	30"	30 1/2"	4' & 8'	275
30"	3 1/2"	3 1/4"	37"	37"	4' & 8'	395
36"	4"	3 3/4"	44"	44"	4' & 8'	540
42"	4 1/2"	4 1/4"	51"	51"	4' & 8'	620
48"	5"	3 3/4"	58"	58"	4' & 8'	895
54"	5 1/2"	4 3/4"	65"	65"	4' & 8'	1105
60"	6"	5"	72"	72"	4' & 8'	1340
66"	6 1/2"	5 1/4"	79"	79"	6' & 8'	1595
72"	7"	5 1/4"	86"	86"	8'	1870
78"	7 1/2"	5 1/4"	93 1/2"	93"	8'	2170
84"	8"	5 1/4"	100"	100"	8'	2490

WEIGHT CAN VARY
SPECIFICATIONS:

LIFT HOLES AS ALLOWED PER SPECIFICATIONS

ASTM C76 - WALL "B" - LATEST
AASHTO M170 - LATEST

CITY OF GREENSBORO

STORM DRAINAGE PIPE
REINFORCED CONCRETE

STD. NO.	REV.
449	08-08